



Facility Profile

Northam Town Hall

Address: Cnr Wellington & Gordon Street, Northam

Room Capacity: 280 seated in rows
140 seated at tables

Floor Area: 225m²

Floors: Timber

Potential Uses: Weddings
Concerts
Birthday Parties
Exhibitions School
Productions Community
Meetings Dancing
Classes Fitness Classes

Features:

- Commercial Kitchen
- Stage (With Curtain)
- Box Office
- Change rooms with Showers
- Kiosk / Bar
- Air Conditioned / Heaters
- Balcony Viewing





Shire of Northam
Heritage, Commerce and Lifestyle



Location Map



Directions From Perth/Midland

Take the Great Eastern Hwy towards Kalgoorlie (79km)

Turn right onto Mitchell Ave, at the round about take the 2nd exit (4.2km)

Turn Right onto Newcastle Road (78m)

Continue onto Gairdner St (450m)

At the Roundabout take the 1st exit onto Wellington St (300m)

Floor Plan

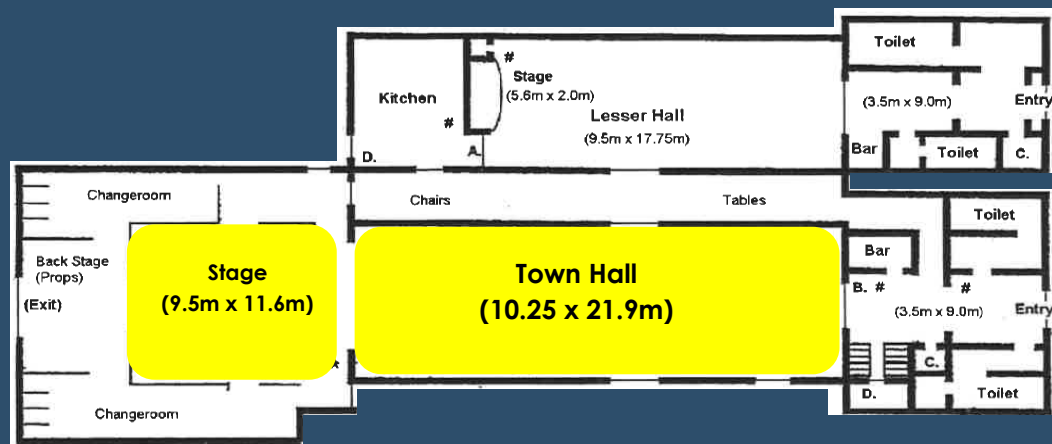

Want to hire this facility?

For bookings please contact the Northam Recreation Centre on 9622 5153 or email bookings@northam.wa.gov.au